

Rye Harbour Farm

Habitat Creation Project

No.1 May 2010

Restoring a nationally important area for wildlife

This summer the Environment Agency would like to begin the restoration of Rye Harbour Farm, re-creating habitats lost to the site for more than 50 years.

Rye Harbour Farm was purchased to assist in the creation of the sea defence embankment from Winchelsea Beach to Rye Harbour. Since completing the embankment, we have been developing a project to restore many of the habitats that once existed in the area.

The Rye Harbour area has European-wide importance for bird populations and rare shingle habitat which is rich with wild flowers and insects. It also forms part of the Dungeness, Romney Marsh and Rye Bay Site of Special Scientific Interest (a national designation for its wildlife and geological significance).

This project will re-create 17 hectares of inter-tidal habitat near Lime Kiln Cottage, restore many of the shingle ridges and create new areas of fresh water wetlands at the Winchelsea Beach end of the site (see map overleaf).

As well as significantly extending the Rye Harbour Nature Reserve, the project will also contribute to the Environment Agency's national commitment to creating and restoring important habitats.

On 6th May we submitted a planning application for the works to Rother District Council. Details of how you can view the planning application are overleaf.



Part of Rye Harbour Farm and the adjacent Local Nature Reserve 2008 by Rye Harbour Nature Reserve



Redshank – by Barry Yates, Rye Harbour Nature Reserve

Proposed timetable of the project

30th May 2010: Site tour – everyone welcome
11am meet at Lime Kiln Cottage
3-6km walk, approx 1.5 hours.

August 2010: The landscaping phase begins.

Ponds and scrapes will be created by removing clay from the western end of the site.

The two pits near Lime Kiln Cottage will be filled using this material. Filling the pits will not only protect the existing landfill from disturbance but it will also limit the volume of water that can enter the site.

Top soil will also be stripped from some of the shingle ridges to begin restoring this habitat.

All other existing wetland features will be retained and protected.

Winter 2010/11: The construction phase begins.
Construct culverts & penstock to provide a managed link to the tidal River Rother.
Construct a new outfall through the existing river wall.

Spring 2011: Scheme complete.

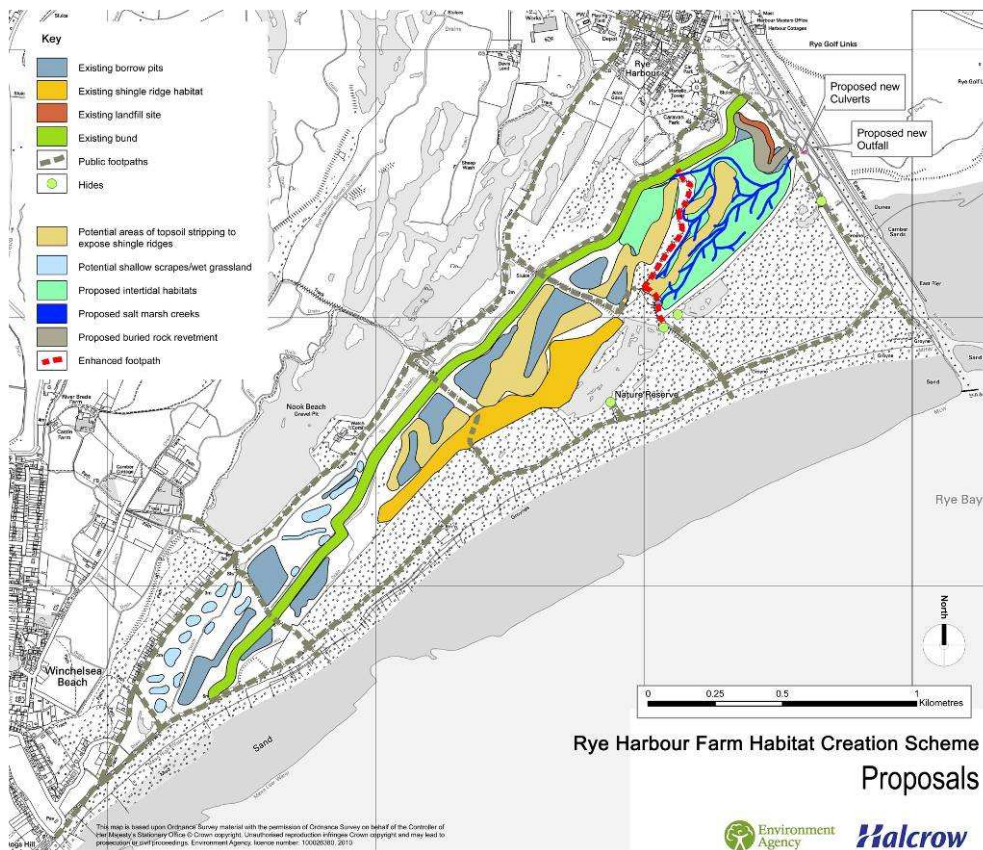

Map showing the proposed habitat creation

Will the public footpaths still be open?

Yes, all public footpaths will remain open throughout construction. However where works cross footpaths, these will be manned for safety reasons, and there may be minor diversions.

Will there be much noise during construction?

Noise will be restricted to normal working hours. There will be some increased noise levels during construction, particularly when building the new outfall adjacent to Lime Kiln Cottage.

What additional opportunities for viewing wildlife will there be?

All of the habitat creation will be visible from footpaths around the site. We already work in partnership with Rye Harbour Nature Reserve which has recently opened a brand new bird watching hide.

What impact will there be on flood risk?

The scheme will not alter flood risk.

Who can I contact to find out more information?

Peter Richardson	Project Manager	01903 832099
Ian Nunn	Project Executive	01903 832609
Tom Cook	Technical Officer, Fisheries, Recreation & Biodiversity	01732 222912

Where can I read a copy of the Environmental Statement?

Copies of the Planning Application (RR/2010/1149/P) & Environmental Statement can be viewed at:

Environment Agency, Scots Float Depot, Military Road, Playden, Rye, East Sussex, TN31 7PH
 Rother District Council, Planning Division, Town Hall, Bexhill on Sea, East Sussex, TN39 3JY
 Lime Kiln Cottage, Rye Harbour Nature Reserve, Rye Harbour, East Sussex
 Or on the Rother District Council Website www.rother.gov.uk

The next newsletter will be available in August 2010